

Micro Flow Switch with Factory Set Switch Point



measuring
•
monitoring
•
analyzing

KSR / SVN



- Flow Switch for Low Volumes of Water or Air
- Reed Contact or Proximity Switch
- Vertical Connections for In-line Mounting
- Switching Ranges: 0.03...4.0 GPH (Water)
0.1...13 SCFH (Air)



Contact:
Industrial Process Measurement, Inc.
3910 Park Avenue, Unit 7
Edison, NJ 08820
732-632-6400
support@instrumentation2000.com
<http://www.instrumentation2000.com>



Description

KOBOLD micro flow switches, models KSR and SVN, operate on the same principle as a float-type or variable area flow indicator. Provided that the flow rate is above a preselected minimum, the float is raised from its seat and travels the full distance to its upper stop. The model SVN utilizes an inductive proximity switch which transmits a signal to a suitable power supply/relay module, such as our KFA- or KFD-series, triggering a user specified signaling or switching sequence. The model KSR contains a magnet within its float, which activates an electrically isolated reed-switch. As long as the maximum switching capacity of the reed switch is not exceeded, no supplemental relay is required to provide a triggering function. If additional switching capacity is required, KOBOLD can supply an appropriate isolation relay to protect the flow switch contacts from overload damage.



Specifications

Switching Ranges (Factory Set)

- Water:** 0.03...4.0 GPH (Model SVN)
0.03...2.5 GPH (Model KSR)
- Air:** 0.1...13 SCFH (at STP)
- Max. Temp:** 160 °F
- Max. Pressure:** 230 PSIG
- Wetted Parts:** 303 SS, FKM, Borosilicate Glass
- Housing:** Anodized Aluminum
- Mounting:** Vertical, Upward Flow
- Fitting:** 1/4" NPT , G 1/4

Dimensions (mm)

SVN..
w/Proximity Switch

KSR..
w/Reed Switch

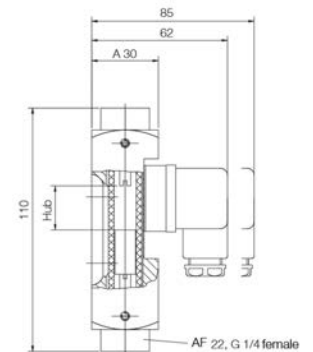
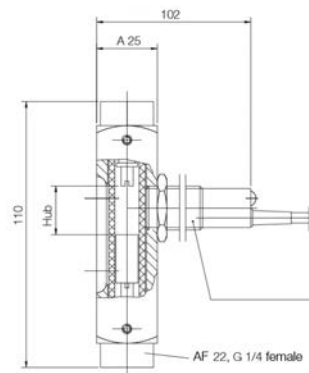

Order Details (Example: **SVN-1200 W N08; 3 GPH Increasing Flow Rate**)

Model Number	Limit Switch	Media	Connection	Set Point (Specify in Writing)
SVN-1200..	Proximity Switch, NAMUR Output 7.7-9 VDC, 2-wire	..W.. = Water	..N08.. = NPT 1/4"	Example: 5 SCFH Decreasing Flow
SVN-1201..	Proximity Switch, DC Voltage 10-35 VDC, 3-wire NPN, N/O Contact			
KSR-1200..	Reed Contact N/O Max. 24 V/0.1 A/1 W	..L.. = Air	..R08.. = G 1/4	
KSR-1201..	Reed Contact SPDT Max. 100V/0.5 A/5 W			